

Jasper Yates in right of Patrick Rice

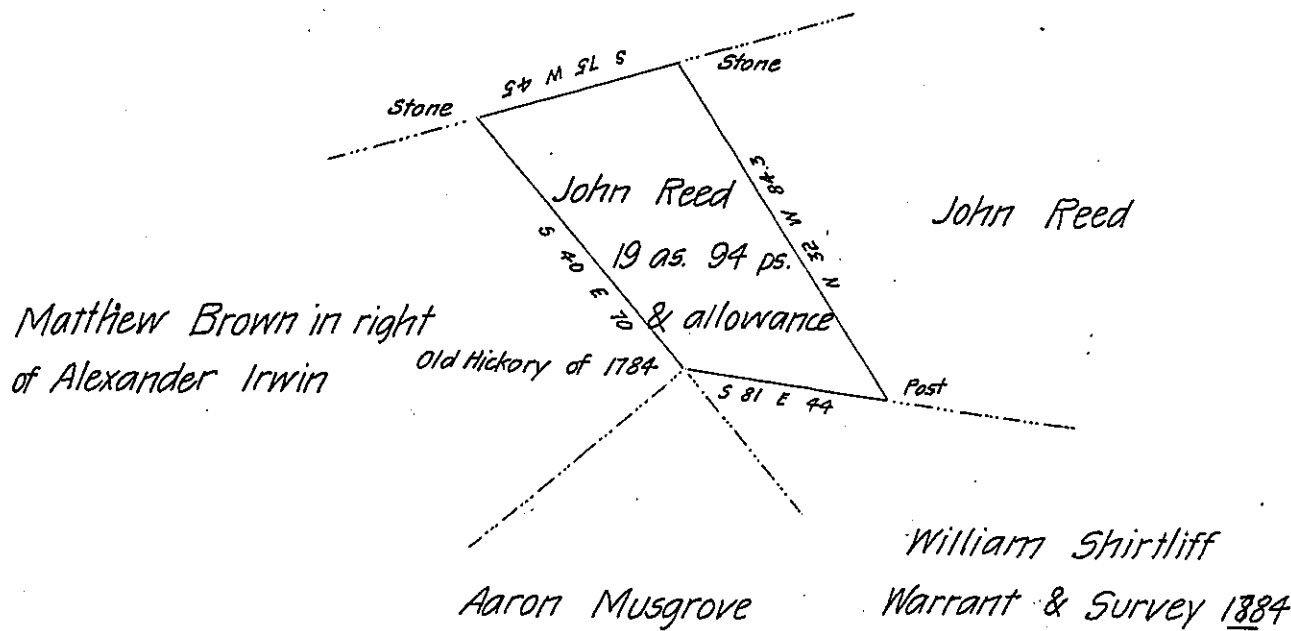

Draft of a tract of land situated in Lamar township Clinton County
 Originally Surveyed on Warrant granted to John Reed dated June 21st 1886 and
 seventy acres and eighty perches returned and upon a careful resurvey for the heirs
 of Christian Bittner deceased, Only nineteen acres and ninety four perches and allow-
 ance remains outside of the William Shirliff Survey of July 1st 1784 Resurveyed the
 above tract May 25th 1870

To

J. M. Campbell Esqr.

S. G.

For J. L. Eckel C. S.

By Joseph F. Quay Deputy.

IN TESTIMONY that the above is a copy of the original remaining on file in
 the Department of Internal Affairs of Pennsylvania, made
 conformably to an Act of Assembly approved the 16th day of
 February, 1833, I have hereunto set my Hand and caused
 the Seal of said Department to be affixed at Harrisburg,
 this nineteenth day of September 1906

Leason Brown
 Secretary of Internal Affairs.